

# Retractable PFS Corporation Stops



***Retractable PFS Corporation Stops have been designed to inject chemical into the center stream of the flow and provide easy and reliable uptime maintenance.***

- retractable frame allows installation and retrieval of the quill under full operating pressure up to 1000 PSIG
- Titanium Gr. 5 retractable rod for compact design
- 3 materials of construction for greater durability: 316 S/S, Alloy 20 and Hastelloy
- connection in NPT, metric or flanged
- extensive variety of designs, materials and size configurations to best suit your application
- custom sizes and designs available
- temperatures to 176°C (350°F)
- retrofit kit is available for standard PFS Corporation Stops

***For detailed product information visit our website: [primaryfluid.com](http://primaryfluid.com)***



**PRIMARY FLUID  
SYSTEMS INC.**

Call Toll Free 1-800-776-6580  
Tel (905) 333-8743 Fax (905) 333-8746

E-Mail: [primary@primaryfluid.com](mailto:primary@primaryfluid.com)  
[www.primaryfluid.com](http://www.primaryfluid.com)



# Retractable PFS Corporation Stops

For detailed product information visit our website: [www.primaryfluid.com](http://www.primaryfluid.com)

## Ordering and Dimensional Information

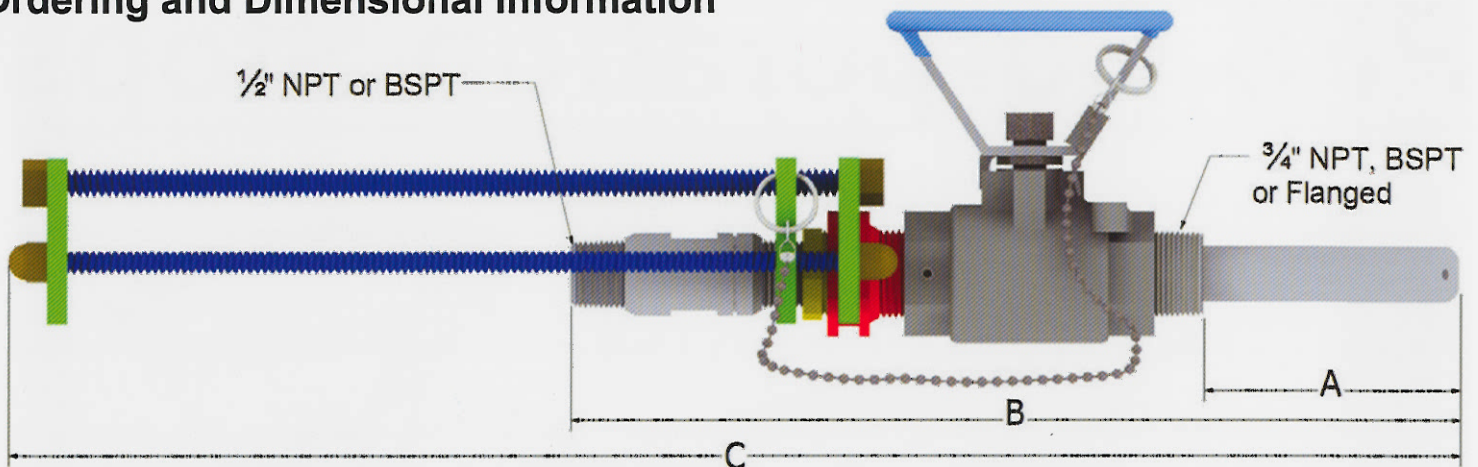

| Model*      | Gland Seal Material** | Dimensions |        |        | Pressure***<br>Max. PSIG | Temperature<br>Max. |
|-------------|-----------------------|------------|--------|--------|--------------------------|---------------------|
|             |                       | A          | B      | C      |                          |                     |
| CCSR-56-X-Y | Viton                 | 2.625"     | 9.50"  | 16.00" | 1000                     | 350°F (176°C)       |
| CCSR-58-X-Y | Viton                 | 4.625"     | 11.50" | 18.00" | 1000                     | 350°F (176°C)       |

\* suffix X and Y represent the materials of construction and an option respectively  
 e.g. 2.625" quill with 316 S/S body and Hastelloy C spring is CCSR-56-316S/S-H  
 \*\*optional gland seal material available; \*\*\*maximum pressure @ 70°F (21°C) working temperature

Other materials of construction and bubble tight/resilient seat check valve available on request.

### Material of Construction - X

| Suffix      | Body Material | Spring/Ball Check Material |
|-------------|---------------|----------------------------|
| 316 S/S     | 316 S/S       | 316 S/S                    |
| Alloy 20    | Alloy 20      | See optional suffix        |
| Hastelloy C | Hastelloy C   | Hastelloy C                |

### Optional Spring/Ball Suffix - Y

| Material    | Spring | Ball Check | BSPT Thread<br>Suffix Model number -B<br>(e.g. CCSR-B-56-HASTC) |
|-------------|--------|------------|---|
| 316 S/S     | -S     | -SB        |   |
| Hastelloy C | -H     | -I         |   |
| Titanium    | -TS    | -TB        | Flanged<br>Suffix Model number -F<br>(e.g. CCSR-F-56-HASTC)     |

### Retrofit Kit

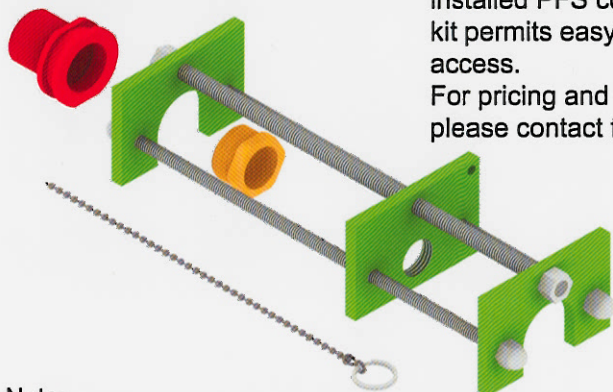

A retrofit kit is available for currently installed PFS corporation stops. The kit permits easy and safe uptime access.

For pricing and detailed information, please contact factory.

Note:

\*all of the above corporation stops are available with 3/4" connections (76 and 78). Corporation stops have standard 1/8" discharge orifice for high velocity discharge. Optional 1/4" discharge orifice available for higher capacity flow.

### Capacities at Given Pressure (US & Metric)

| Pressure |     | Flow Rate |       |           |       |
|----------|-----|-----------|-------|-----------|-------|
|          |     | 1/8" Bore |       | 1/4" Bore |       |
| psi      | kPa | USGPM     | LPM   | USGPM     | LPM   |
| 20       | 138 | 0.05      | 0.19  | 0.70      | 2.65  |
| 30       | 207 | 1.35      | 5.11  | 1.42      | 5.38  |
| 40       | 276 | 1.68      | 6.36  | 2.51      | 9.50  |
| 50       | 345 | 2.03      | 7.68  | 3.43      | 12.98 |
| 60       | 414 | 2.25      | 8.52  | 4.24      | 16.05 |
| 70       | 483 | 2.51      | 9.50  | 4.94      | 18.70 |
| 80       | 552 | 2.76      | 10.45 | 5.52      | 20.90 |
| 90       | 621 | 2.99      | 11.32 | 6.13      | 23.20 |
| 100      | 689 | 3.21      | 12.15 | 6.81      | 25.78 |

Distributed By:



PRIMARY FLUID  
SYSTEMS INC.

Distribution Territories Available

Call Toll Free 1-800-776-6580

Tel: (905) 333-8743

Fax: (905) 333-8746

E-Mail: [primary@primaryfluid.com](mailto:primary@primaryfluid.com)

[www.primaryfluid.com](http://www.primaryfluid.com)